

# Kohala Ranch Vacant Land & Homes Available For Purchase

as of 04/15/2024

---

## Vacant parcels in the Heathers Section (lower elevations):

Lot #	Size of parcel	Listed Price	Listing Agents' Comments
247	3.58 acres	\$369,000	existing site work clearly defines building pad
303	3.08 acres	\$390,000	build your dream home here
259	3.46 acres	\$450,000	end of the cul de sac, with prime seclusion
236	3.79 acres	\$500,000	private and secluded building site

---

## Vacant parcels in Heathers II (slightly higher elevations):

821	41,600 square feet	\$499,000	special and rare lower elevation lot
819	35,384 square feet	\$509,000	be enchanted by the unrivaled beauty

---

## Vacant parcels in the Meadows One Section (middle elevations):

458	*	3.07 acres	\$299,000	offers several building site choices
438	*	3.72 acres	\$335,000	don't let the low price fool you
481		3.25 acres	\$399,000	approximately 1,900 feet above sea level
423		3.18 acres	\$415,000	sweeping panoramic views
498	*	3.44 acres	\$439,000	backs up to hundreds of vacant acres
372	*	3.19 acres	\$445,000	adjacent to two 10-acre parcels
398		3.00 acres	\$500,000	parcel offers stunning views

---

## Vacant parcels in the Meadows Two Section (middle elevations):

621	*	5.07 acres	\$499,000	this 5+ acre lot checks all the boxes
-----	---	------------	-----------	---------------------------------------

---

## Vacant parcels in the Summit Section (higher elevation):

142		10.33 acres	\$545,000	positioned at a slightly cooler elevation
116		10.20 acres	\$550,000	an unparalleled vantage point
132		10.02 acres	\$575,000	feel on top of the world
110		10.26 acres	\$695,900	beautiful mountain, ocean and sunset views

---

## Already-built houses:

Lot #	Location	Lot Size	Size of House	# Bedrooms/Bathrooms	Listed Price
144	Summit	12.97 acres	2889 square feet	3 / 3,0,1	\$2,995,000
328	Heathers	5.00 acres	3675 square feet	4 / 4,0,0	\$4,240,000
835	Heathers II	1.09 acres	2769 square feet	4 / 3,0,1	\$4,600,000

*NOTE: The Number of Bathrooms is shown as "#,#,#" to mean Full (with a tub), ¾ (with shower), ½ (powder room)*

---

For a tour of Kohala Ranch, contact Jim Donovan at (808) 880-9000.

Jim Donovan represents buyers, unless otherwise disclosed.

\* Except for lots #372, #438, #458, #498 and #621, properties discussed herein are listings of other real estate agents who represent the sellers.

Hoku Star Realty  
James M. Donovan, Principal Broker  
JD-CPA@Kona.net

James M. Donovan is licensed in both Hawaii and California as both a Real Estate Broker and as a Certified Public Accountant. License numbers are HI RB-19185, HI CPA-3417, CA RB-0930737 and CA CPA-19485. Both states' real estate licenses are active, both states' CPA licenses are current, and all licenses are in good standing. However, Jim is inactive as to the profession of public accounting.

*Hoku Star Realty*  
**HokuStar.com**  
 (808) 880-9000

James M. Donovan, Principal Broker  
 RB-19185

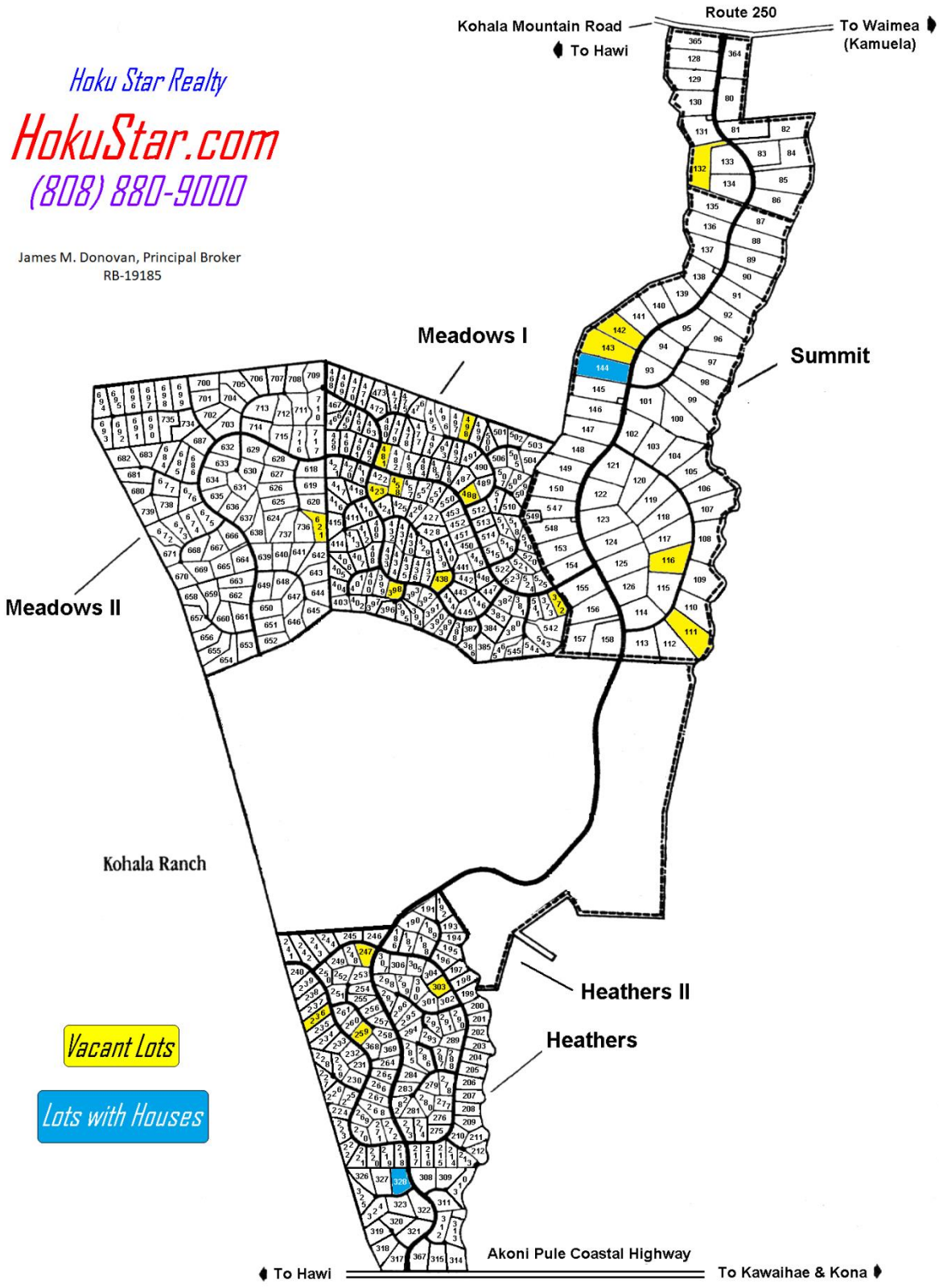

Lots with Houses

Vacant Lots

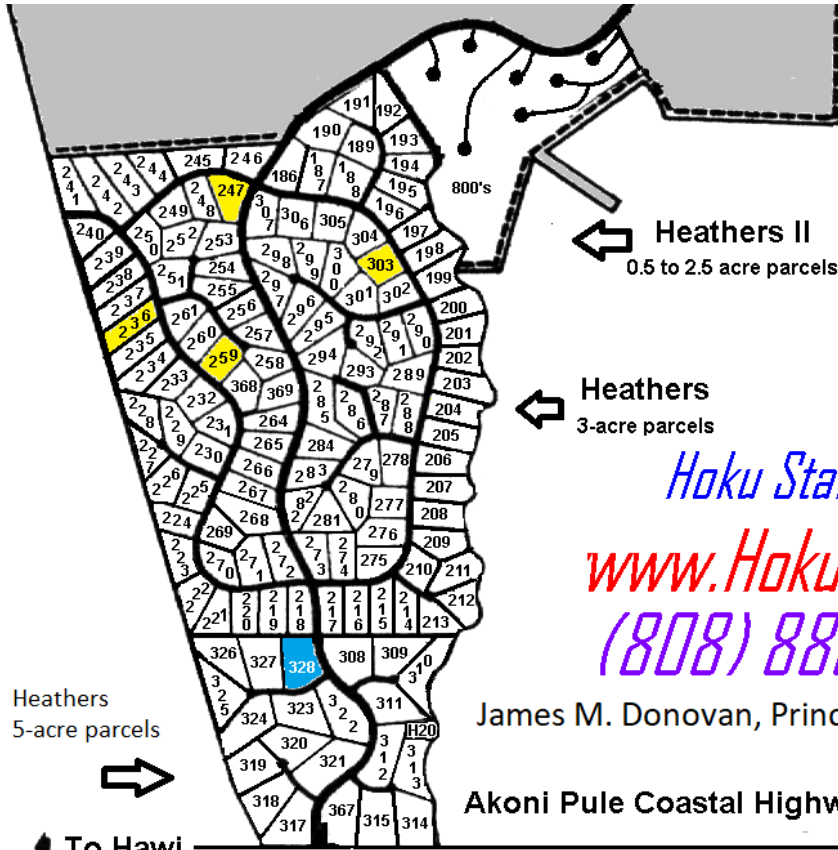

Heathers II  
0.5 to 2.5 acre parcels

Heathers  
3-acre parcels

Heathers  
5-acre parcels

*Hoku Star Realty*

*www.HokuStar.com*

*(808) 880-9000*

James M. Donovan, Principal Broker, RB-19185

Akoni Pule Coastal Highway

◆ To Hawi

To Kawaihae & Kona ◆

**Heathers II**  
**1/2 acre to 2.5 acre lots**

**For a tour of Kohala Ranch,  
call Jim Donovan at  
(808) 880-9000**



**You can look up  
any and all Big Island**

**MLS listings at [www.HokuStar.com](http://www.HokuStar.com)**

**Hawaii Hoku Star Realty, LLC**  
**James M. Donovan, Principal Broker**

RB-19185

Copyright, 2024



# Kohala Ranch - Meadows II

*Hoku  
Star  
Realty*

*www.HokuStar.com*

James M. Donovan  
RB-19185

*(808) 880-9000*

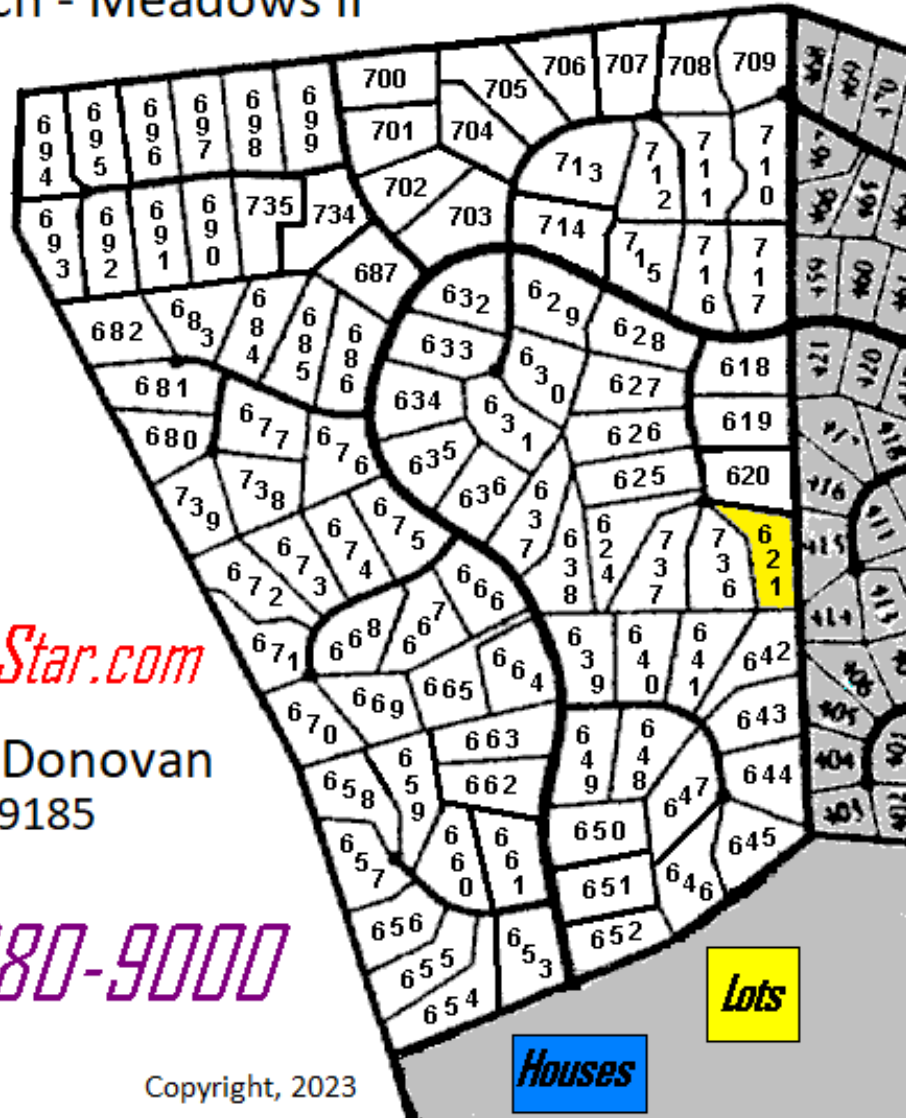

Copyright, 2023

Kohala Mountain Road **To Hawi** **Route 250** **To Waimea (Kamuela)**

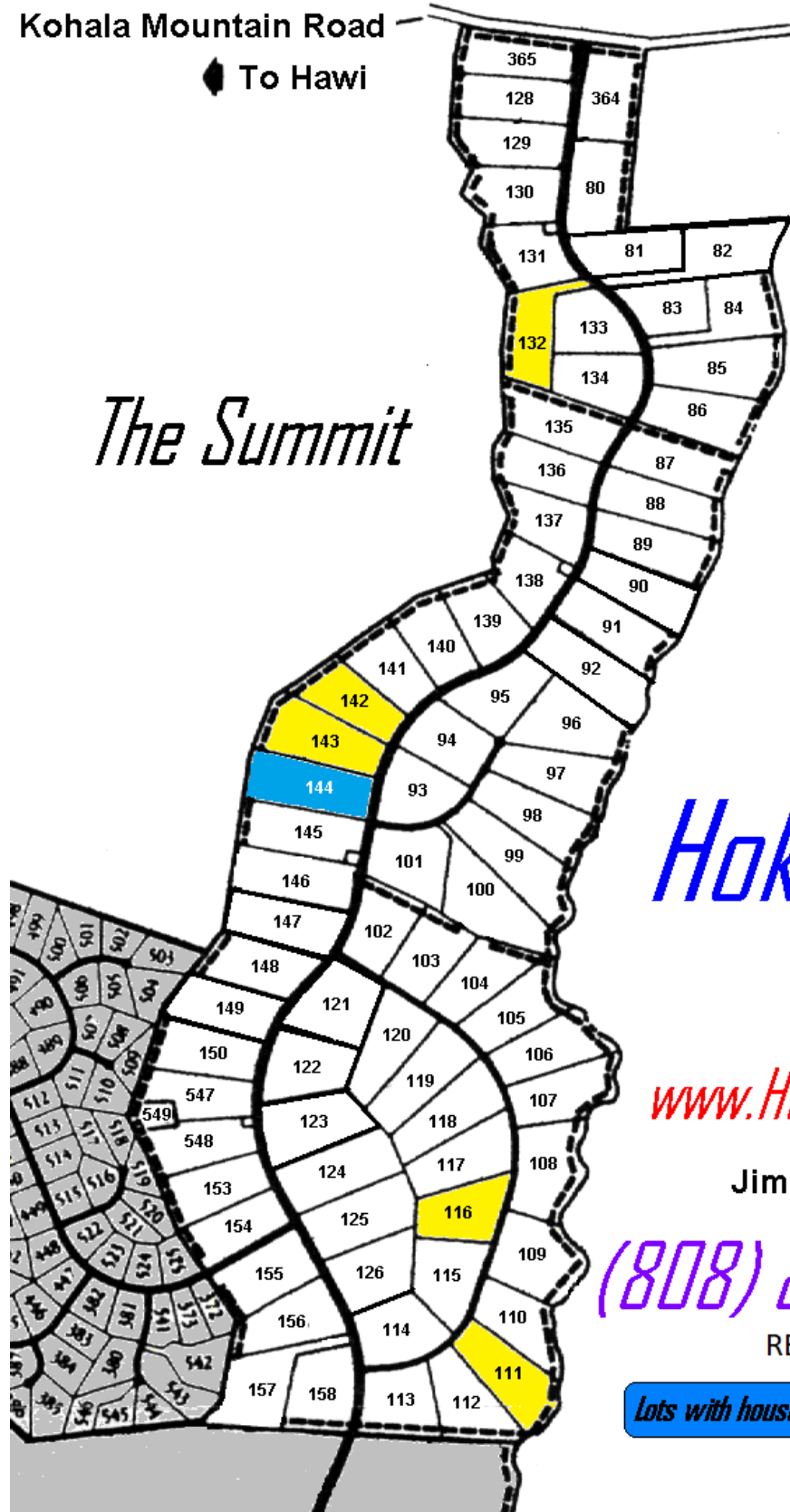

*The Summit*

**Hoku Star**  
*Realty*

[www.HokuStar.com](http://www.HokuStar.com)

Jim Donovan

**(808) 880-9000**

RB-19185

**Lots with houses**

**Vacant lots**